

Masters'

ARBOGA

vertical miller

EM 825

for faster

DIE, JIG AND FIXTURE WORK

- * Now available with speeds 125 to 2500.
- * 20" working space below the spindle, 1/1000 graduations on the handwheel.
- * 22" table as optional equipment.

for precision

DRILLING, MILLING, BORING

Distributors in all major cities of the United States.

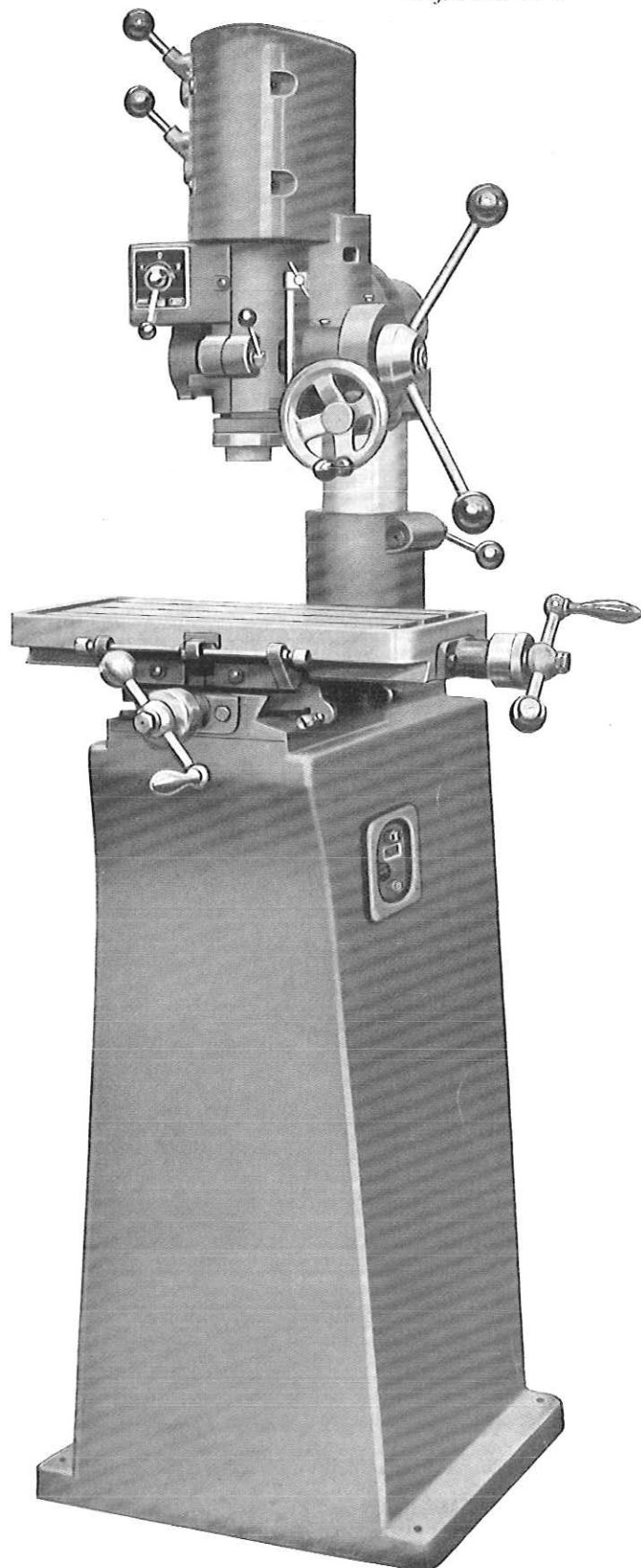

Authorized Distributor

Marshall Tool & Supply Corporation



2850 E. Olympic, Los Angeles, CA 90008 www.SterlingMachinery.com

Phone ANgelus 3-6121

Vertical Miller

EM 825

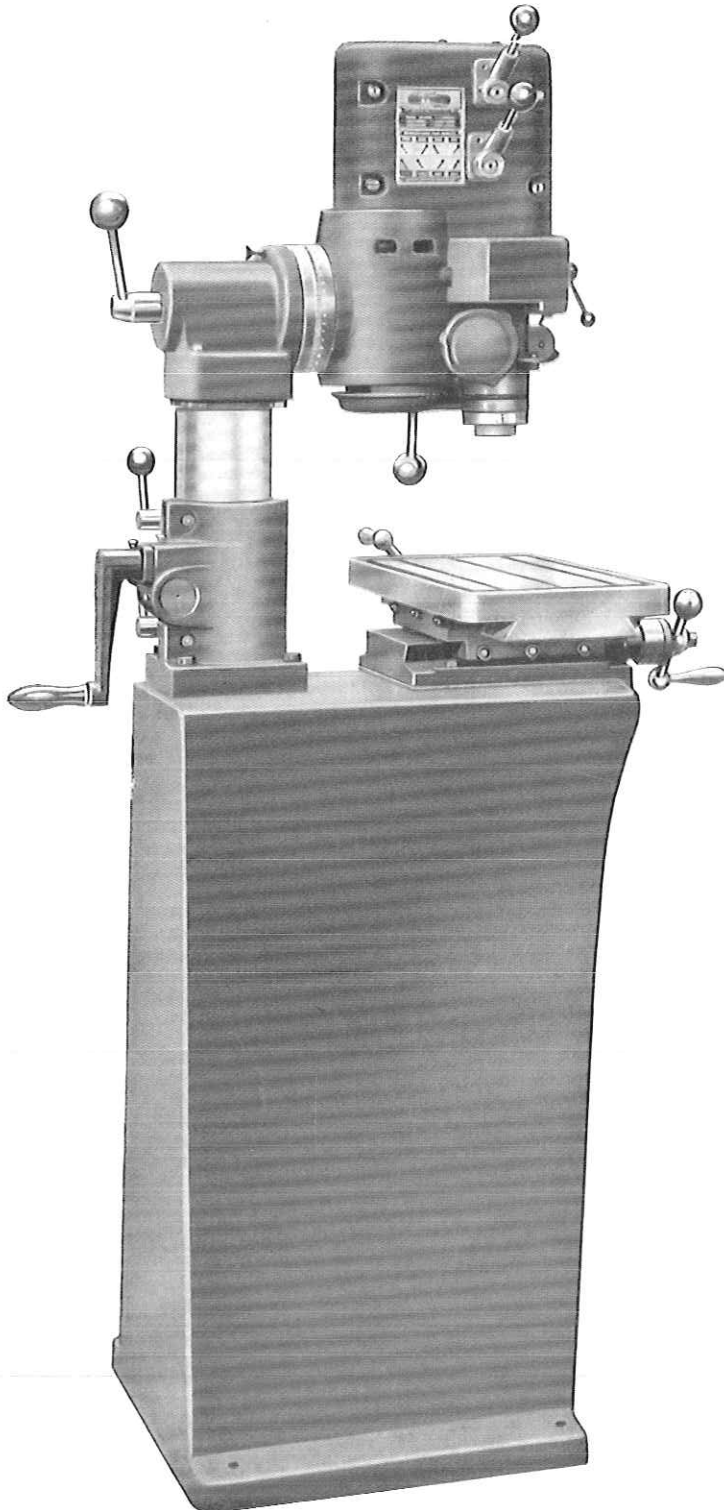

Machines manufactured by

The machine is rigidly constructed, yet a fast-working and simple handled machine which is very suitable for both small and large shops, it drills, mills, bores and reams at all angles with one work set up.

The table, carefully indexed with respect to the spindle, is machined on all sides; the feed screws are made according to the latest methods, and the corresponding verniers graduated to 1/500 inch. The surface of the table has two T-grooves, one on each side of a central guide groove, and an oil groove encircles the table. The ways are very carefully milled and at exactly right angles. Both are provided with stops fitted with adjusting screws.

The lower spindle bearing is located at the outer end of the tapered sleeve to provide for greatest stability also when milling.

Instead of a drawbar the spindle nose is threaded and fitted with a nut for locking the tools.

End mill adapters are available.

The motor, of two-speed pole change type, is obtainable for single-phase or three-phase AC, 60 cycles. As it cannot be switched for different line voltages, the desired line voltage should always be stated in the order. Additional charge on single phase.



ARBOGA SWEDEN

www.SterlingMachinery.com
EXCLUSIVELY FOR THE R. S. KINNEY CO IN THE U. S.

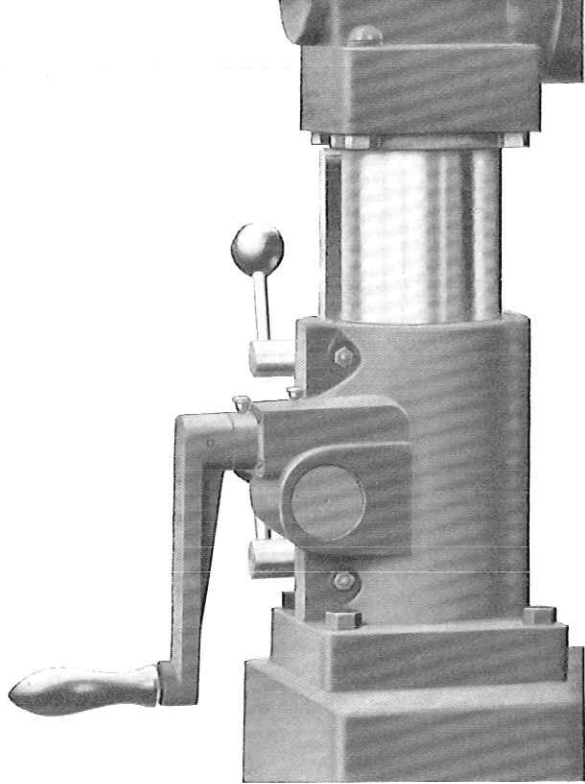

STEADY VERTICAL MOVEMENT

The drilling head moves vertically on the supporting column by means of a crank-operated rack-and-worm mechanism. The rack, ground flat on both sides, is let into the column. Lateral play is obviated by an adjustable, carefully shaved bar.

HANDWHEEL OPERATED SLOW-FEED WITH .001 GRADUATIONS

Rapid feed of the spindle is obtained by means of a lever which acts direct on a rack on the spindle sleeve. For milling and boring, a slow-feed worm mechanism operated by a hand-wheel, is provided. The vernier of the hand-wheel is graduated to 1/1000 inch. The feed can be braked to desired harshness, or completely locked, by the lever located on the front of the spindle housing.

The drill head can be swiveled through 45 deg. to either side, the angle of displacement being read on a scale graduated 45-0-45. The head is locked in the desired position by means of a lever behind the bearing housing. A special stop is provided for the zero position.

Four speeds of the gear box plus the two speed settings of the motor give 8 spindle speeds, in all. Machine is delivered with the speeds given in the table, but is obtainable, on request, with a higher speed range.

125, 245, 300, 550, 630, 915
1250, 2500 r/m

Sterling
MACHINERY EXCHANGE

www.SterlingMachinery.com

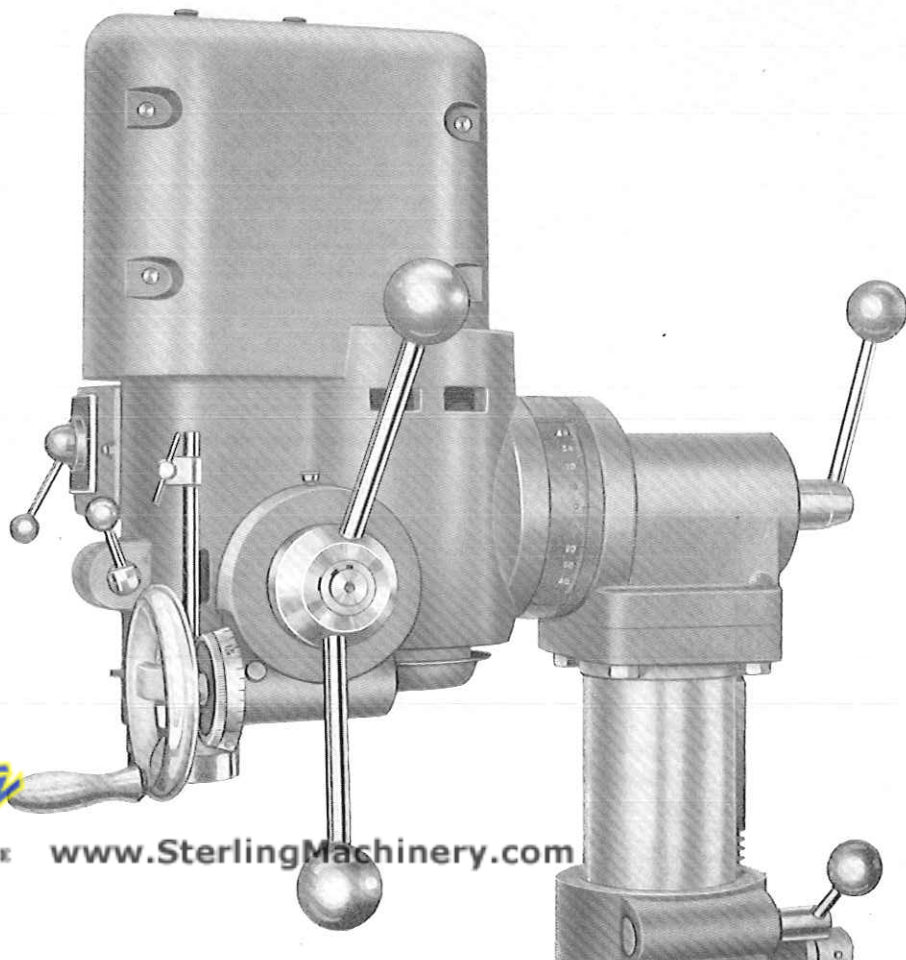

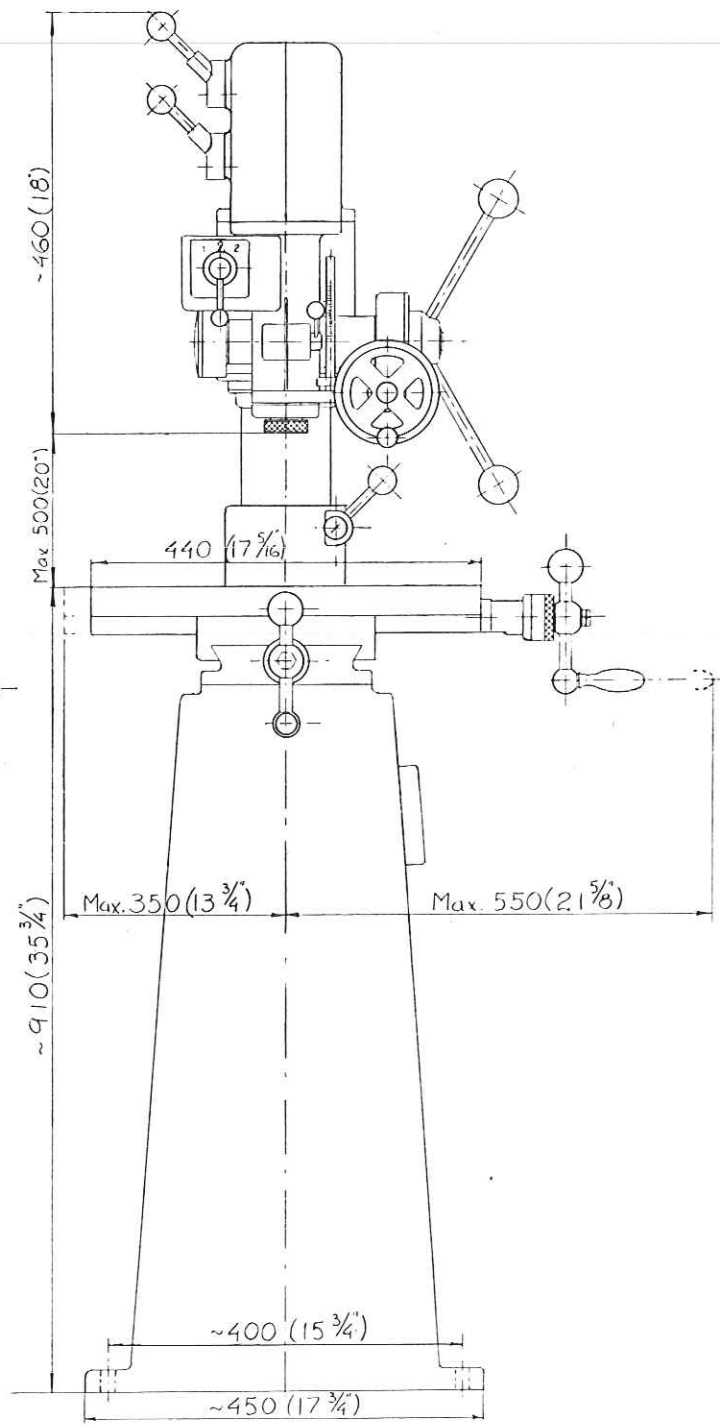
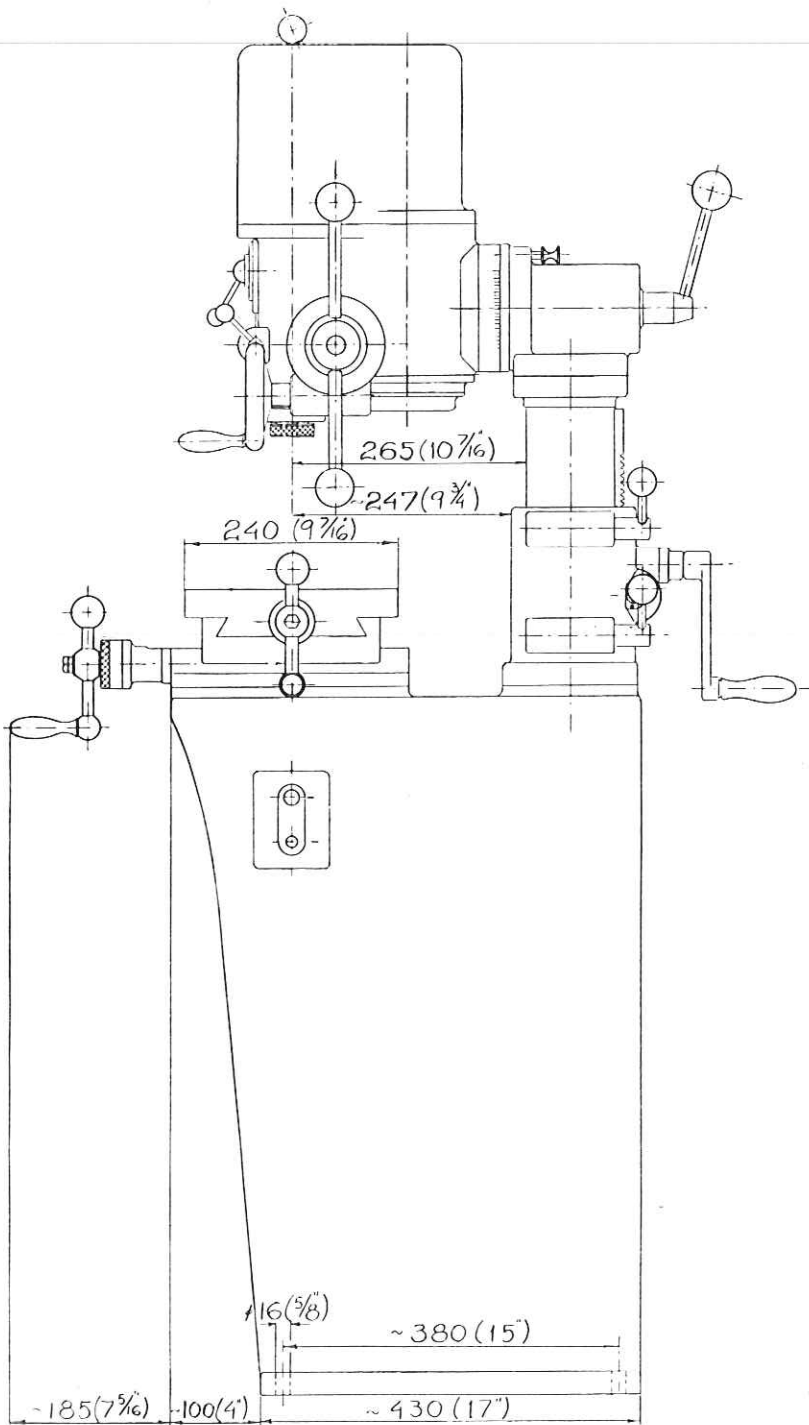

SPECIFICATION

| | |
|--|---|
| Distance centre of spindle to column | 10 7/16" |
| Distance centre of spindle to bearing housing for column | 9 3/4" |
| Maximum distance spindle nose to table surface | 20" |
| Traverse of drill spindle | 4 1/2" |
| Diameter of column | 4" |
| Working surface of table * | 17 5/16 × 9 7/16" |
| Traverse of table, longitudinal* | 11" |
| Traverse of table, cross | 6 1/2" |
| Maximum drilling diameter in steel | 1" |
| Power of motor at 3400 r/m | 1.1 HP |
| " " " " 1700 | 0.9 HP |
| Range of spindle speeds r/m | 125, 182, 250, 365, 530, 770, 1060, 1540 |
| Taper socket in spindle, standard morse | No. 3 |
| Net weight (in lbs) | 530 |

*) Also available with working surface of table 22" x 9 7/16". Longitudinal traverse 15 1/2".